

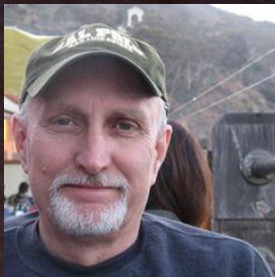

Advanced Analytics

Advanced Analysis of Student Data



Terry Scott | Aeries Trainer

terrys@aeries.com

March 2024

Information shared throughout this presentation is the property of Aeries Software. Information or images may not be reproduced, duplicated, or shared without the prior written consent of Aeries Software.

Topics

Item Definitions – backend configuration of nightly data searches

- Overview of types of student data for use in Analytics
- Understand the setup of various Item Definition types, copy mechanism
- Delineating Item Definition Thresholds
- Defining Early Warning System Indicators
- Creating Label Layouts
- Creating Sub-groups based on Item Definitions

Dashboards – front end

- Creating, displaying various types of Dashboard Items
- Sharing Dashboards
- Filtering Dashboards
- Identifying Student Data Sets
- Exporting Analytics charts or data

Watch Lists

- Using Watch Lists to identify at-risk students
- Viewing and Understanding Student Indicator Details



Analytics Setup Process

Analytics Setup

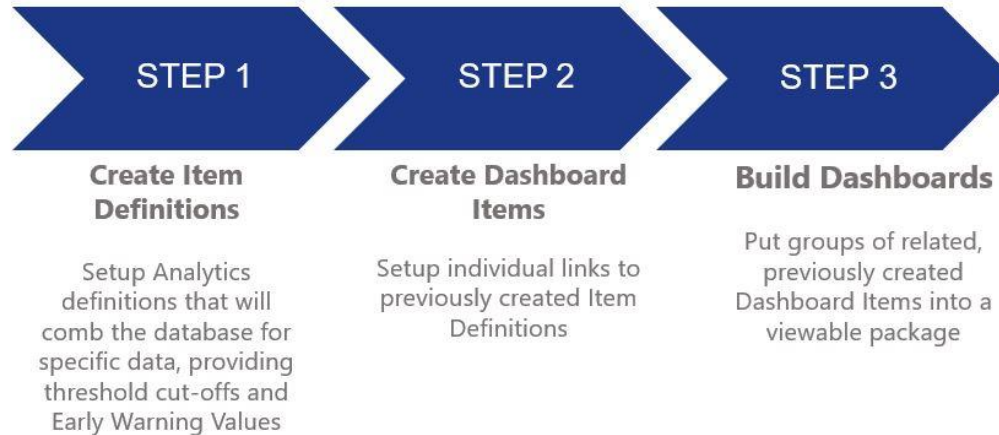

Analytics Item Definitions – backend configuration

ATT: Attendance % ▾

Definition Student Sub Groups Summary Data Label Layouts

Save Cancel Delete Copy

Title ATT: Attendance %

Short Title Att %

Type ATT Percentage ▾

Label Layout Attendance % ▾

Early Warning Indicator ☒

Last Updated 10/1/2018 12:05 AM

Date Range to

If these dates are left blank then the entire school year will be processed.

Save Cancel Delete Copy

Indicator Thresholds

Add Threshold

	School	Grade	NA	1 - Severely Chr...	EWV 1	2 - Chronic Atte...	EWV 2	3 - Approaching...	EWV 3	4 - Meets Atten...	EWV 4	5 - Perfect Atte...	EWV 5
Edit Copy	All	All	<input type="checkbox"/>	0 - 89	10	90 - 95	7	96 - 97	4	98 - 99	0	100 - 100	0

Analytics Item Definitions – Types

Attendance

- **Attendance Threshold** (total number of days absent)
Groups students into district-defined levels based on count of actual days absent; needs Date Range (or leave blank) and Absence Codes to Include (check each)
- **Attendance %**
Groups students into district-defined levels based on percentage of student attendance (all day codes); needs Date Range (or leave blank)



Analytics Item Definitions – Types

Discipline

- **ADS Violation Count**

Groups students into district-defined levels based on the number of times each student has received a specific ADS Violation (infraction) - needs Date Range (or leave blank) and Assertive Discipline codes to Include

- **ADS Disposition Count**

Groups students into district-defined levels based on the number of times each student has received a specific ADS disposition code - needs Date Range (or leave blank) and Disposition Codes to Include

- **Disposition Days**

Counts and places students into district-defined levels based on a count of days for students receiving selected Disposition Codes - example: days of Suspension - needs Date Range (or leave blank) and Disposition Codes to Include (check each)

- **Intervention Count**

Counts the number of times students have received specific Intervention codes and places them in district-defined levels - example: the number of times students receive Peer Counseling; needs Date Range (or leave blank) and Intervention Codes to Include (check each)

Analytics Item Definitions – Types

Grades

Counts students with specific grades and places them in district-defined levels - example: current English gradebook grades

Limit By:

-Subject Area and Subject Area Name (from HS Grad Requirements)

OR

-Department Code and Department Name (usually used by middle schools)

Which Mark in GRD

-Most Recent GRD Mark

-Most Recent HIS (transcript)

-Most Recent Gradebook

-M1 to M12 (choose one) - specific marking periods - Qtr 1, semester, etc



Analytics Item Definitions – Types

Demographics and table data

Analyze fields within STU or other tables

- **Field Value**

Counts values in certain field in a certain table and places students into district-defined levels - example Language Fluency (STU.LF)

- **Field Value Range**

Counts values within specified ranges in a certain field in a certain table and places students into district-defined levels - example: Long Term English Learners Years in Program - LAC.YP

Analytics Item Definitions – Types

Testing - Analyze Test Scores

TST - places students into district-defined levels based on scores in the TST table - example: SBAC Math Most Recent Proficiency Levels

- Test ID
- Test Part
- Date Options
- Date Range
- Test Admin
- Score Field

CST - counts and places students into district-defined levels based on scores from CST table

- Test ID
- Test Part
- Date Options
- Date Range
- Test Admin
- Score Field



Analytics Item Definitions – Types

Program

- Free/Reduced
- Socio-Economic Disadvantaged
- Special Ed
- Gate
- 504 Plan
- any code from PGM table

- *Label Layout*

- *Program*



Analytics Item Definitions – Types

College - Various ways to analyze how students are progressing toward being prepared for college

- **CCI (Career College Indicator)**

Career / College Indicator - groups students into district-defined levels of progress toward the maximum CCI level of “Prepared” --- Measure (A, B, C, D, E, Overall)

- **College Entrance Requirements (UC/CSU)**

Counts and places students into district-defined levels based on completed credits in UC or CSU required subjects - one subject at a time

- *UC / CSU (choose one)*
- *Subject Area (A-G)*



Analytics Item Definitions – Types

Graduation Requirements –

Counts student credits in a specific subject area and places them into district-defined levels - one subject at a time

- *Subject Area*



Other Item Definition Types:

- - Attendance Notes
- - Gradebook Missing Assignments
- - Intervention Counts
- - Retention Counts



“Generic” Item Definition Types:

- Count of Codified Text Field

- Record Exists Y/N

- Sum of A Number Field

Aeries Analytics 2023-2024 Eagle Unified School District admin Logout

Fall Sports ▾ Definition Student Sub Groups Summary Data Label Layouts

Save Cancel Delete Copy

Title Fall Sports

Short Title FallSPRT

Type Count of Codified Text Field ▾

Label Layout Sports Count ▾

Early Warning Indicator ☐

Last Updated 12/30/2023 7:52 AM

Table to Count ACT - Activities and Awards ▾

Table with Codified Field ACT - Activities and Awards ▾

Field CD - Code ▾

Date Filtering Type Occurrence Date ▾

Table with Date Field(s) ACT - Activities and Awards ▾

Occurrence Date Field DT - Date ▾

Date Options Any Time This Year ▾

Codes to Include

Associated	Code	Description
<input type="checkbox"/>	G04	Financial Aid Application
<input type="checkbox"/>	100	Archery
<input type="checkbox"/>	101	Badminton
<input type="checkbox"/>	102	Baseball
<input type="checkbox"/>	103	Basketball
<input type="checkbox"/>	104	Bowling
<input type="checkbox"/>	105	Boxing
<input type="checkbox"/>	106	Crew
<input checked="" type="checkbox"/>	107	Cross Country

Save Cancel Delete Copy

Indicator Thresholds

Add Threshold

	School	Grade	NA	1 - 1 Sport	EWV 1	2 - 2 Sports	EWV 2	3 - 3 Sports	EWV 3	4 - 4 Sports	EWV 4	5 - 5 Sports
Edit Copy	All	All	<input type="checkbox"/>	1 - 1	0	2 - 2	0	3 - 3	0	4 - 4	0	5 - 5



The school principal wants charts which show the Attendance % and Total Days Absent for all students in his school.



The school counselor wants charts which show how well all high school students are doing in their current English and Math class gradebooks.





The school testing coordinator wants a watchlist for all students who have a low score on the most recent SBAC Math and English Overall scores.

Creating Item Definitions with subgroups

- Built for charting

- Built only for filtering

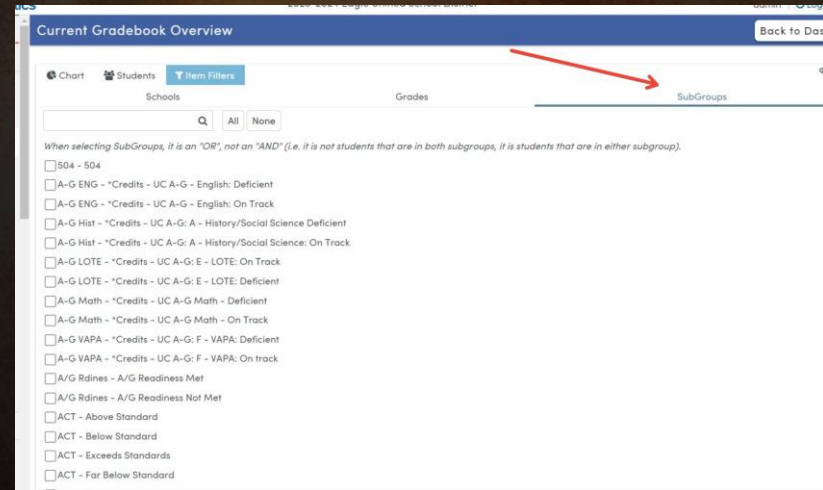

Label Layouts – backend configuration

Series Analytics 2023-2024 Eagle Unified School District

ADS – Days of Suspension ▾ Definition Student Sub Groups Summary Data Label Layouts

CCI Overall

Graduation Requirement

CCI Measure

Test Performance Levels

Default

Attendance %

Grades

EL Status

Program Participation

PFT Status

Attendance Threshold

Attendance Notifications

SBAC Performance Levels

SBAC Claim Levels

Add Layout

Code ATT

Name Attendance %

Level Code Description Color

1	0-89%	Severely Chronic Attendance	<div><div></div></div>
2	90-95%	Chronic Attendance	<div><div></div></div>
3	96-97%	Approaching Chronic Attendance	<div><div></div></div>
4	98-99%	Meets Attendance Standard	<div><div></div></div>
5	100%	Perfect Attendance	<div><div></div></div>

Save Cancel

Legend on Chart

Testing Analysis:

ACT

i-Ready

IB

AP

NWEA MAP

PSAT

CAASPP

PFT

PreACT

ELPAC

SAT

**Local
Benchmarks**

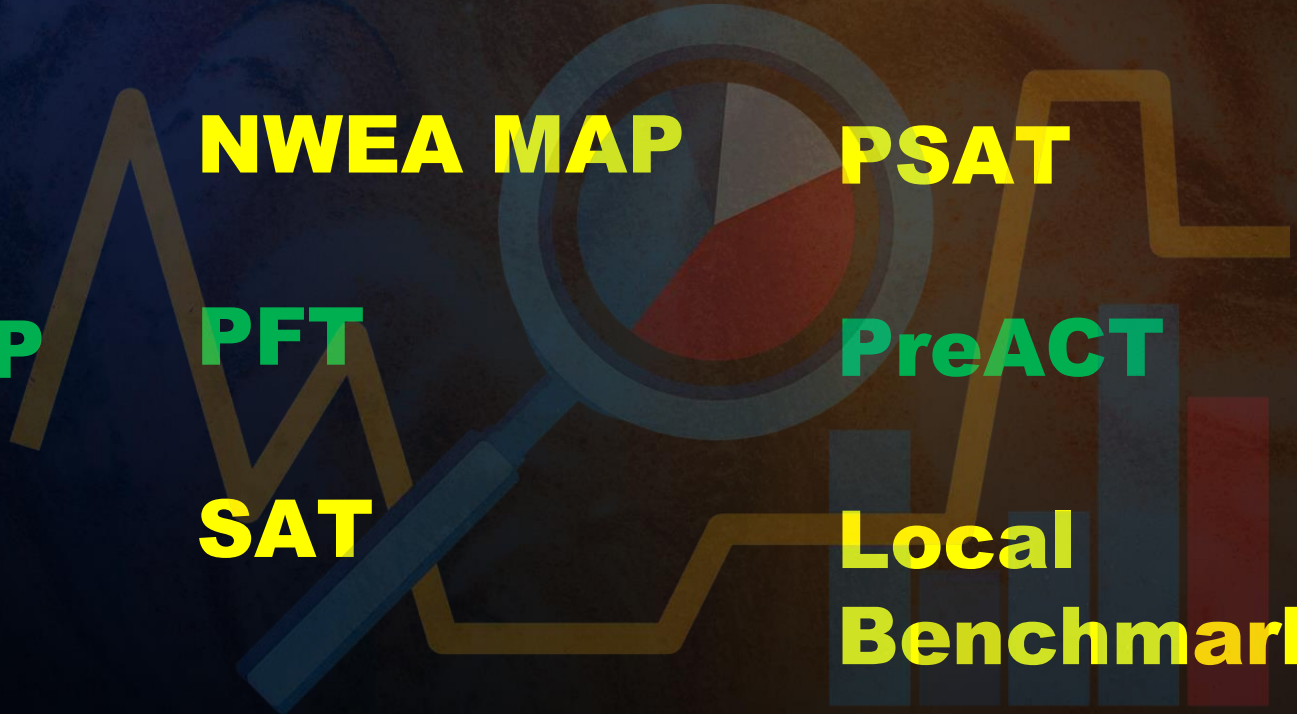

Questions or Comments?



- Creating Item Definitions
- Creating Dashboards
- Creating Charts as Dashboard Items
- Creating Watchlists as Dashboard Items
- Sharing Dashboards as desired
- <https://aeries.link/2023ACSSurvey>





Share your Feedback:



AERIESCON